

Type	: Rechargeable Nickel Metal Hydride Cylindrical Cell
Nominal Dimension (with Sleeve)	: $\Phi = 10.5\text{mm}$ H = 36.2mm
Applications	: Recommended discharge current 40 to 1200mA
Nominal Voltage	: 1.2V
Capacity	: Nominal: 400mAh Minimum: 400mAh Typical: 420mAh When discharged at 80mA to 1.0V at 20°C
Charging Condition	: 40mA for 16 hrs at 20°C
Fast Charge	: 200mA to 400mA (0.5 to 1C) charge termination control recommended control parameters: - ΔV : 0-5mV **DT/dt : 0.8°C/min (0.5 to 0.9C) 0.8 - 1°C/min (1C) **TCO : 45 - 50°C **Timer : 105% nominal input ** for ref. only
Service Life	: >500 cycles (IEC standard)
Continuous Overcharge	: 40mA maximum current for 1 year. No conspicuous deformation and/or leakage
Weight	: 9.30g
Internal Resistance	: Average 80m Ω upon fully charged (Range 70 - 90m Ω) at 1000Hz
Max. Charging Voltage	: 1.5V at 40mA charging
Ambient Temperature Range	: Standard Charge : 0 to 45°C Fast Charging : 10 to 45°C Discharge : -20 to 50°C Storage : -20 to 35°C

Model No.: **GP40AAH**

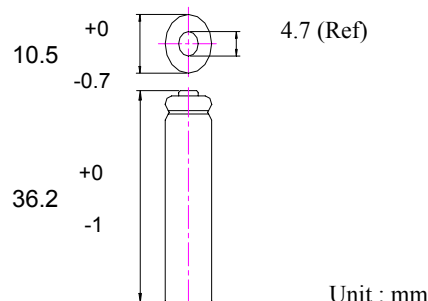

Low Rate Discharge

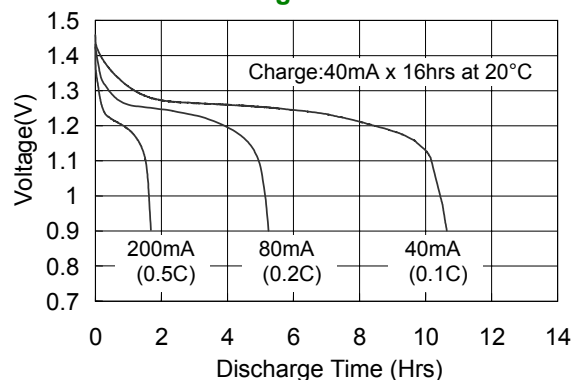

Fast Charge (Charge control required)

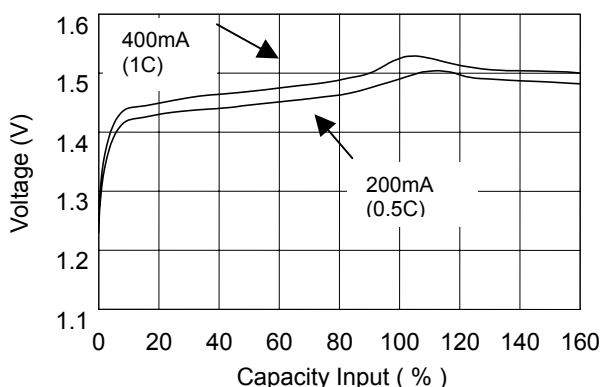

High Rate Discharge

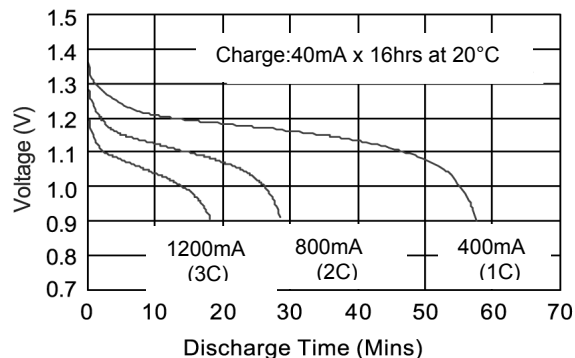

The information (subject to change without prior notice) contained in this document is for reference only and should not be used as a basis for product guarantee or warranty. For applications other than those described here, please consult your nearest GP Sales and Marketing Office or Distributors.