

GP Batteries

Data Sheet

Model No.: GP400CHC

Type	: Rechargeable Nickel Metal Hydride Cylindrical Cell	
Nominal Dimension (with Sleeve)	: $\varnothing = 26.2\text{mm}$ H = 50.0mm	
Application	: Recommended discharge current 800mA to 12A	
Nominal Voltage	: 1.2V	
Nominal Capacity	: Minimum : 3880mAh Typical: 4000mAh when discharged at 800mA to 1.0V at 20°C	
Charging Condition	: 400mA for 16 hrs at 20°C	
Fast charge	: 2A (0.5C) with charge termination control Recommended control parameter: -delta V: 0 - 5mV dT/dt: 0.8 deg. C/min TCO: 45-50 deg. C Timer: 100% nominal input	
Service Life	: >500 cycles (IEC 61951-2) Up to 1000 cycles (not less than 60% of nominal at 0.1C charge / 0.2C discharge)	
Continuous Overcharge	: 400mA maximum current No conspicuous deformation and /or leakage	
Weight	: 82 g	
Internal Resistance	: Average 6m Ω upon fully charged (Range : 4-8m Ω) at 1000Hz	
Max. Charging Voltage	: 1.5V at 400mA charging	
Temperature Range	Standard Charging	: 0°C to 40°C
	Fast Charging	: 10°C to 40°C
	Discharging	: -20°C to 50°C
	Storage	: -20°C to 35°C
	Storage (1 week)	: -20°C to 60°C

*

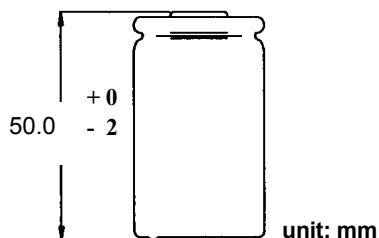
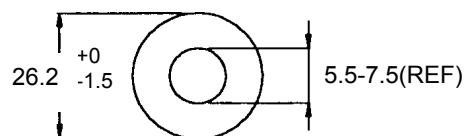

Fast Charge (Charge Control Required)

Voltage (V)

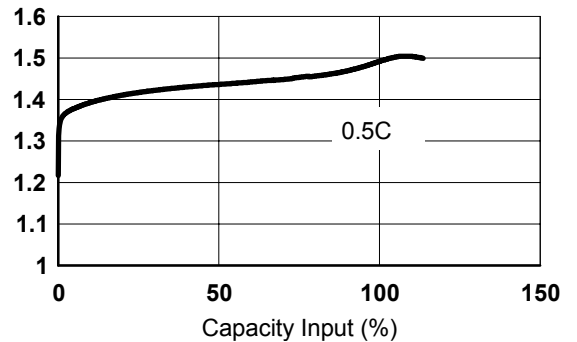

Low Drain Discharge

Voltage (V)

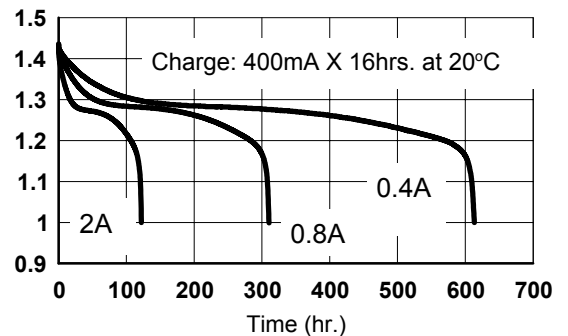

High Drain Discharge

Voltage (V)

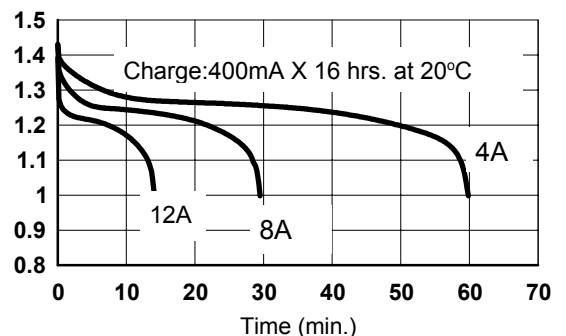

* The information (subject to change without prior notice) contained in this document is for reference only and should not be used as a basis for product guarantee or warranty. For applications other than those described here, please consult GP Sales and Marketing Office or Distributors.